

1. The information shown on this drawing is based on the information provided to the Surveyor by the Client. The Surveyor has not conducted a field inspection of the site and has not verified the accuracy of the information provided. The Client is responsible for the accuracy of the information provided.

TOPOGRAPHICAL SURVEY
 1. The information shown on this drawing is based on the information provided to the Surveyor by the Client. The Surveyor has not conducted a field inspection of the site and has not verified the accuracy of the information provided. The Client is responsible for the accuracy of the information provided.

2. The information shown on this drawing is based on the information provided to the Surveyor by the Client. The Surveyor has not conducted a field inspection of the site and has not verified the accuracy of the information provided. The Client is responsible for the accuracy of the information provided.

TOPOGRAPHICAL SURVEY
 1. The information shown on this drawing is based on the information provided to the Surveyor by the Client. The Surveyor has not conducted a field inspection of the site and has not verified the accuracy of the information provided. The Client is responsible for the accuracy of the information provided.

2. The information shown on this drawing is based on the information provided to the Surveyor by the Client. The Surveyor has not conducted a field inspection of the site and has not verified the accuracy of the information provided. The Client is responsible for the accuracy of the information provided.

3. The information shown on this drawing is based on the information provided to the Surveyor by the Client. The Surveyor has not conducted a field inspection of the site and has not verified the accuracy of the information provided. The Client is responsible for the accuracy of the information provided.

RPS
 REGISTERED CIVIL ENGINEERS
 1. The information shown on this drawing is based on the information provided to the Surveyor by the Client. The Surveyor has not conducted a field inspection of the site and has not verified the accuracy of the information provided. The Client is responsible for the accuracy of the information provided.

Client: **TURNER & TOWNSEND**

Project: **QUEEN ELIZABETH HIGH SCHOOL, HESHAM, NE65 3JB**

Title: **TOPOGRAPHICAL SURVEY**

Date: 15/08/2018
 Drawn by: [Name]
 Checked by: [Name]
 Scale: 1:1000

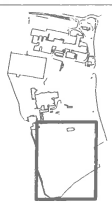

© 2015 RPS Group

This drawing has been prepared as a professional engineering drawing under the supervision of a Professional Engineer. It is not to be used for any other purpose without the written consent of RPS Group. The user of this drawing is advised that it is not to be used for any other purpose without the written consent of RPS Group.

PROFESSIONAL ENGINEER'S DECLARATION:

I, **CHRISTOPHER J. TURNER**, a Professional Engineer, do hereby certify that I am the author of this drawing and that I am a duly Licensed Professional Engineer in the State of Virginia, License No. 55000. I am not aware of any false or misleading information contained in this drawing.

PROFESSIONAL ENGINEER'S SIGNATURE:

Christopher J. Turner

PROFESSIONAL ENGINEER'S TITLE:

Professional Engineer

PROFESSIONAL ENGINEER'S FIRM:

RPS GROUP, INC.

PROFESSIONAL ENGINEER'S ADDRESS:

10000 RIVERSIDE DRIVE, SUITE 200, FALLS CHURCH, VA 22044

PROFESSIONAL ENGINEER'S PHONE:

(703) 441-1100

PROFESSIONAL ENGINEER'S FAX:

(703) 441-1101

PROFESSIONAL ENGINEER'S E-MAIL:

turner@rps.com

PROFESSIONAL ENGINEER'S REGISTRATION STATE:

VA

PROFESSIONAL ENGINEER'S REGISTRATION NUMBER:

55000

PROFESSIONAL ENGINEER'S EXPIRATION DATE:

12/31/2016

PROFESSIONAL ENGINEER'S LICENSE TYPE:

Professional Engineer

PROFESSIONAL ENGINEER'S LICENSE CLASSIFICATION:

Professional Engineer

PROFESSIONAL ENGINEER'S LICENSE CATEGORY:

Professional Engineer

PROFESSIONAL ENGINEER'S LICENSE SUB-CATEGORY:

Professional Engineer

PROFESSIONAL ENGINEER'S LICENSE SPECIALIZATION:

Professional Engineer

PROFESSIONAL ENGINEER'S LICENSE SPECIALIZATION CODE:

Professional Engineer

PROFESSIONAL ENGINEER'S LICENSE SPECIALIZATION DESCRIPTION:

Professional Engineer

PROFESSIONAL ENGINEER'S LICENSE SPECIALIZATION COMMENTS:

Professional Engineer



Registration: Civil/Structural Engineering
7,700 Lakeside Blvd., Suite 100, Falls Church, VA 22044

Client: TURNER & TOWNSEND

Project: QUEEN ELIZABETH HIGH SCHOOL, ROOM 308

Title: TOPOGRAPHICAL SURVEY

DATE	DESCRIPTION
10/15/15	ISSUE FOR PERMIT
10/15/15	ISSUE FOR CONSTRUCTION
10/15/15	ISSUE FOR RECORD
10/15/15	ISSUE FOR AS-BUILT
10/15/15	ISSUE FOR FINAL

Project No. 15-000000-00

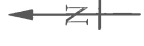



1. The map shall be prepared in accordance with the standards of the Survey Act, 1985, and the Survey Regulations, 1986, and shall be subject to the approval of the Surveyor General of the Province of Ontario.

2. The map shall be prepared in accordance with the standards of the Survey Act, 1985, and the Survey Regulations, 1986, and shall be subject to the approval of the Surveyor General of the Province of Ontario.

3. The map shall be prepared in accordance with the standards of the Survey Act, 1985, and the Survey Regulations, 1986, and shall be subject to the approval of the Surveyor General of the Province of Ontario.

4. The map shall be prepared in accordance with the standards of the Survey Act, 1985, and the Survey Regulations, 1986, and shall be subject to the approval of the Surveyor General of the Province of Ontario.

5. The map shall be prepared in accordance with the standards of the Survey Act, 1985, and the Survey Regulations, 1986, and shall be subject to the approval of the Surveyor General of the Province of Ontario.

6. The map shall be prepared in accordance with the standards of the Survey Act, 1985, and the Survey Regulations, 1986, and shall be subject to the approval of the Surveyor General of the Province of Ontario.

7. The map shall be prepared in accordance with the standards of the Survey Act, 1985, and the Survey Regulations, 1986, and shall be subject to the approval of the Surveyor General of the Province of Ontario.

8. The map shall be prepared in accordance with the standards of the Survey Act, 1985, and the Survey Regulations, 1986, and shall be subject to the approval of the Surveyor General of the Province of Ontario.

9. The map shall be prepared in accordance with the standards of the Survey Act, 1985, and the Survey Regulations, 1986, and shall be subject to the approval of the Surveyor General of the Province of Ontario.

10. The map shall be prepared in accordance with the standards of the Survey Act, 1985, and the Survey Regulations, 1986, and shall be subject to the approval of the Surveyor General of the Province of Ontario.

RPS
 R. P. S. & A. S.
 1000 Dundas Street East, Toronto, Ontario M5G 1A5
 Phone: (416) 461-1111
 Fax: (416) 461-1112
 Email: info@rps.com

Client: TURNER & TOWNSEND

Project: QUEEN ELIZABETH HIGH SCHOOL, PHASE 3.0
 Title: TOPOGRAPHICAL SURVEY

Date: 1999
 Drawn by: [Name]
 Checked by: [Name]
 Approved by: [Name]

Scale: 1:500
 Contour Interval: 1.00m
 Datum: NAD 83

Project No.: 2000-04

